

REVISIONS			
REV	DESCRIPTION	BY	DATE
A	Released for Production	CRE	1/07/04
B	Correct dim to 53.25	CRE	6/20/05

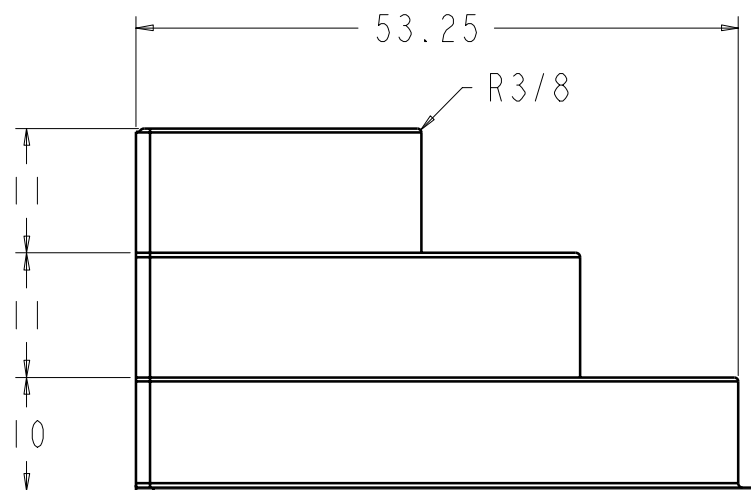
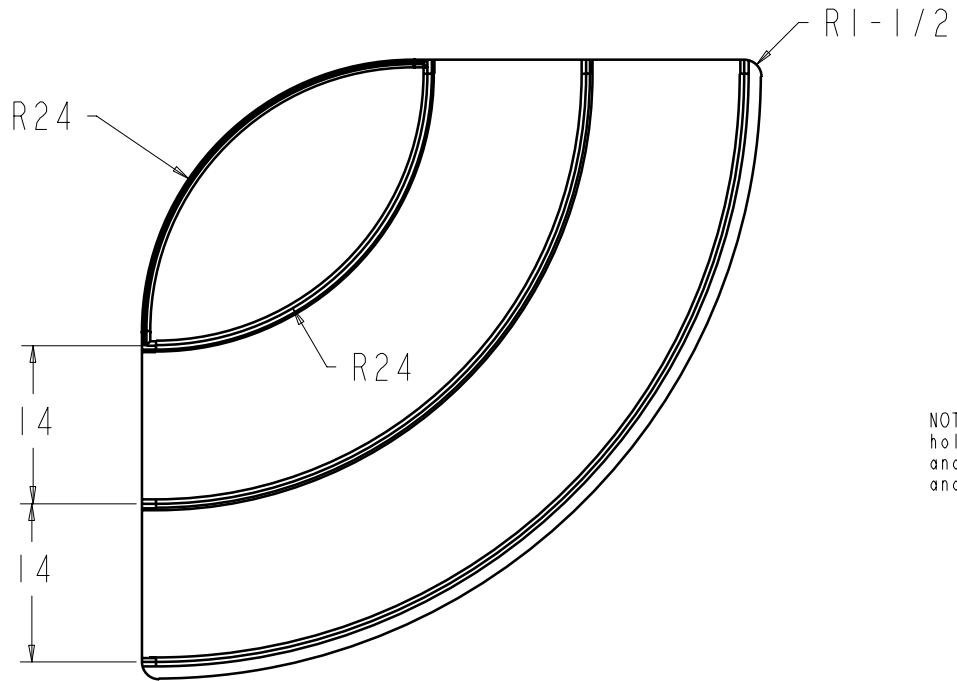

NOTE: Use template to locate .25" diameter holes: 3 on bottom tread, 3 on middle tread and 4 on top tread. These are used for rod clips and must be accurately located.

		<small>This drawing is the property of LATHAM PLASTICS INC. The information is confidential and LATHAM PLASTICS INC. claims PROPRIETARY RIGHTS in the material shown on this drawing. This drawing may not be reproduced for any reason without permission from LATHAM PLASTICS INC.</small>	
<small>787 Watervliet Shaker Road, Latham, NY 12110</small>		<small>TOLERANCES DIMENSIONS ARE IN INCHES</small> x.x ±0.1 x.xx ±0.01 x.xxx ±0.001	<small>TITLE</small> Wedding Cake VO Step 2ft Radius Corner
<small>PART WEIGHT:</small> <small>PART STD COLOR:</small>	<small>DRAWN BY:</small> CRE	<small>DATE:</small> 1/07/04	<small>ANGLE</small> ±0.5
<small>PROCESS:</small> Thermoform	<small>APP BY:</small>	<small>DATE:</small>	<small>THIRD ANGLE PROJ.</small>
<small>PART MATERIAL:</small> ABS	<small>SIZE</small> C	<small>PART NUMBER</small> ST9004001	<small>A</small>
		<small>SHT 1 OF 1</small>	

Part # ST9004

PART NUMBER ST9004001