



Pool Breakdown

OHANA 24' ROUND 52"

This first page lists the quantity, carton number, and carton description for each individual box and/or pallet in your shipment. Check that the numbers and descriptions on your checklist match identically to those on the cartons. Make sure that the pool type, model, shape, and size also line up perfectly. If something is off, even by one number, check to make sure that you have the correct checklist for your pool type and if so, contact our support team immediately at support@royalswimmingpools.com.

<input checked="" type="checkbox"/>	Qty	Carton Product Number #	Carton Content Description
<input type="checkbox"/>	1	350024711727	3/5 24D 711 727 758 ZENITH CLAY TEXTURED
<input type="checkbox"/>	1	450024711727	4/5 24D 711 727 758 ZENITH CLAY TEXT 52"
<input type="checkbox"/>	1	550024727	5/5 24D 727 ZENITH CLAY TEXTURED
<input type="checkbox"/>	1	WPRA52S-WMN24-0906	WALL: PRAIRIES 52" STEEL WM 24

Once you have all of the cartons listed above, continue to the next page. There should be one table per carton and each carton should be gone through entirely before moving on to the next.

Please ensure that you have received the proper quantity for each item listed.

DO NOT THROW CARTONS/BOXES AWAY UNTIL AFTER THE INSTALLATION IS COMPLETE. We recommend taking photos of all labels/stickers on the boxes.

In the unlikely event that you are missing items, please refer to the document Inventory Checklist and Reporting Missing Items that was previously emailed to you.

Once you have ALL items listed on the entire inventory checklist, refer to your safety handbook and installation manual before you start the building process.

CUSTOMER SUPPORT CAN BE REACHED AT ANY OF THE FOLLOWING:

CALL: 901-372-1773

TEXT: 901-472-7797

EMAIL: support@royalswimmingpools.com



Carton Breakdown

OHANA 24' ROUND 52"

Carton Product Number #	Carton Content Description
350024711727	3/5 24D 711 727 758 ZENITH CLAY TEXTURED

√	Key #	Qty	Part #	Part Description
<input type="checkbox"/>	A	17	ART211-1295053	TOP LEDGE ZENITH CLAY TEXTURED 53.250"

*Below items will contain no actual pool parts; just packaging/shipping materials

Qty	Part #	Part Description
2	BTE541808	BOX TEL REVERSIBLE 54"X18"X08" 275C

Carton Product Number #	Carton Content Description
450024711727	4/5 24D 711 727 758 ZENITH CLAY TEXT 52"

√	Key #	Qty	Part #	Part Description
<input type="checkbox"/>	B	17	ART711-R12954M	UPRIGHT ZENITH CLAY TEXT REG 51.750"

*Below items will contain no actual pool parts; just packaging/shipping materials

Qty	Part #	Part Description
2	BTE541810	BOX TEL REVERSIBLE 54"X18"X10" 275C

CUSTOMER SUPPORT CAN BE REACHED AT ANY OF THE FOLLOWING:

CALL: 901-372-1773

TEXT: 901-472-7797

EMAIL: support@royalswimmingpools.com



Carton Breakdown

OHANA 24' ROUND 52''

Carton Product Number #	Carton Content Description
550024727	5/5 24D 727 ZENITH CLAY TEXTURED

√	Key #	Qty	Part #	Part Description
<input type="checkbox"/>	C	17	AR211-23120ABC	LEDGE COVER ZENITH CLAY
<input type="checkbox"/>	*	1	SACWBI36876	SAC DVD D`INSTALLATION TRENDIUM
<input type="checkbox"/>	*	1	SACV12X34-191	BAG 191 SCREW 12-3/4 STAINLESS
<input type="checkbox"/>	F	34	LA1254124	WALL CHANNEL OMEGA TEXT 24D 52.687"
<input type="checkbox"/>	D	17	AR711-23300AC	UPRIGHT COVER ZENITH CLAY
<input type="checkbox"/>	E	34	21120A	JOINER PLATE ZENITH GALVANIZED

*Below items will contain no actual pool parts; just packaging/shipping materials

Qty	Part #	Part Description
2	BTE541808	BOX TEL REVERSIBLE 54"X18"X08" 275C

CUSTOMER SUPPORT CAN BE REACHED AT ANY OF THE FOLLOWING:

CALL: 901-372-1773

TEXT: 901-472-7797

EMAIL: support@royalswimmingpools.com

**OHANA 52
ROUND**

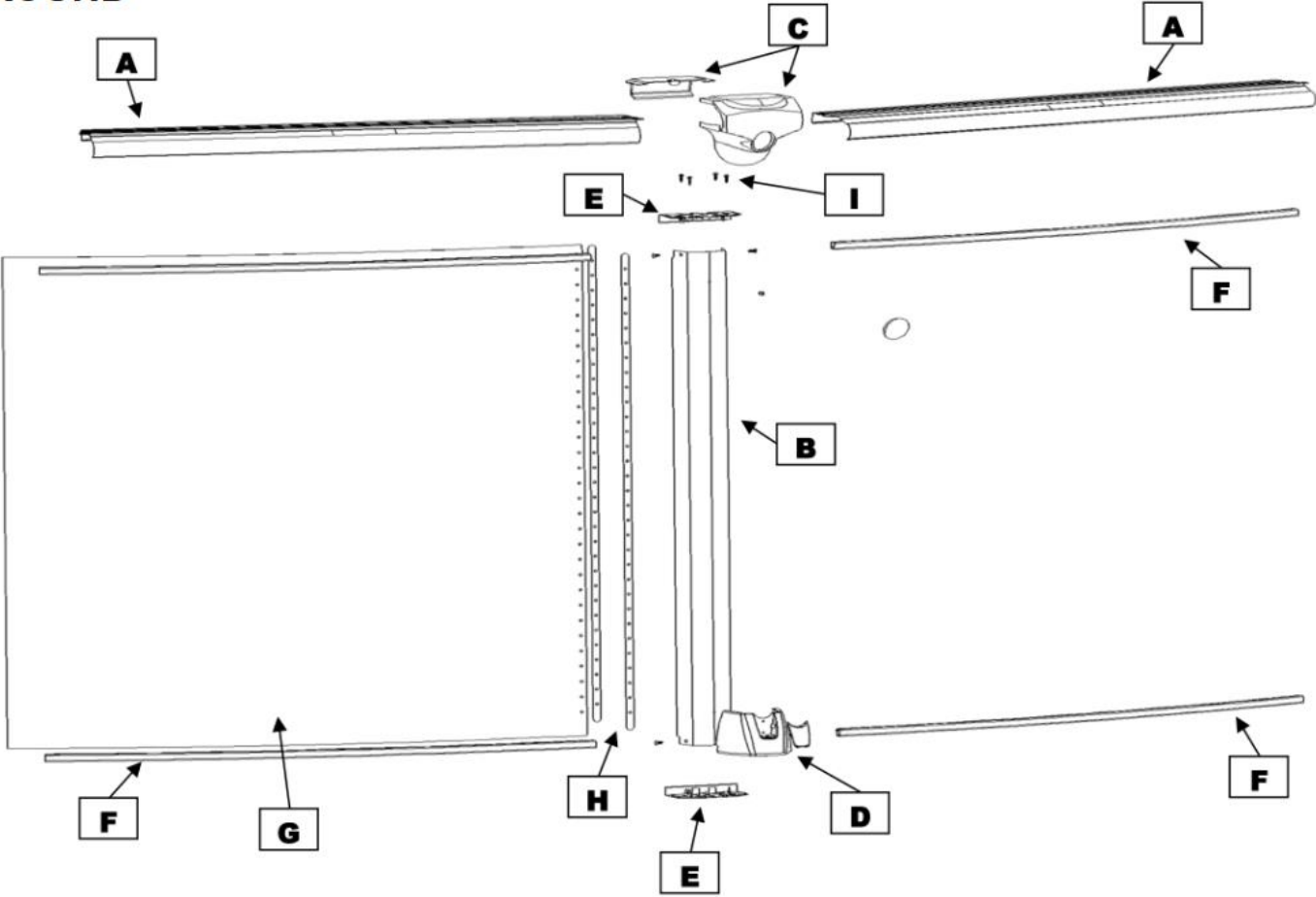

CUSTOMER SUPPORT CAN BE REACHED AT ANY OF THE FOLLOWING:
CALL: 901-372-1773
TEXT: 901-472-7797
EMAIL: support@royalswimmingpools.com