



Pool Breakdown

SALTWATER ULTIMATE 15' ROUND 54''

This first page lists the quantity, carton number, and carton description for each individual box and/or pallet in your shipment. Check that the numbers and descriptions on your checklist match identically to those on the cartons. Make sure that the pool type, model, shape, and size also line up perfectly. If something is off, even by one number, check to make sure that you have the correct checklist for your pool type and if so, contact our support team immediately at support@royalswimmingpools.com.

<input checked="" type="checkbox"/>	Qty	Carton Product Number #	Carton Content Description
<input type="checkbox"/>	1	450015861A	4/5 15D 861 AZOR 54"
<input type="checkbox"/>	1	350015761861A	3/5 15D AZOR 761 861
<input type="checkbox"/>	1	550015761861A	5/5 15D 761 861 AZOR
<input type="checkbox"/>	1	WFAL54S-WMS15-0530	WALL: FALLSTON 54" STEEL WM SS 15

Once you have all of the cartons listed above, continue to the next page. There should be one table per carton and each carton should be gone through entirely before moving on to the next.

Please ensure that you have received the proper quantity for each item listed.

DO NOT THROW CARTONS/BOXES AWAY UNTIL AFTER THE INSTALLATION IS COMPLETE. We recommend taking photos of all labels/stickers on the boxes.

In the unlikely event that you are missing items, please refer to the document Inventory Checklist and Reporting Missing Items that was previously emailed to you.

Once you have ALL items listed on the entire inventory checklist, refer to your safety handbook and installation manual before you start the building process.

CUSTOMER SUPPORT CAN BE REACHED AT ANY OF THE FOLLOWING:

CALL: 901-372-1773

TEXT: 901-472-7797

EMAIL: support@royalswimmingpools.com



Carton Breakdown

SALTWATER ULTIMATE 15' ROUND 54''

Carton Product Number #	Carton Content Description
450015861A	4/5 15D 861 AZOR 54"

√	Key #	Qty	Part #	Part Description
<input type="checkbox"/>	B	10	CG861-002-54	UPRIGHT RESIN RE 54" REVELATION 861

*Below items will contain no actual pool parts; just packaging/shipping materials

Qty	Part #	Part Description
2	BTE572416	BOX TEL REVERSIBLE 57" X 24" X 16" 275C

Carton Product Number #	Carton Content Description
350015761861A	3/5 15D AZOR 761 861

√	Key #	Qty	Part #	Part Description
<input type="checkbox"/>	A	10	CG761-001-R	TOP LEDGE UNIV RESIN REVELATION 761 861

*Below items will contain no actual pool parts; just packaging/shipping materials

Qty	Part #	Part Description
2	BTE571910	BOX TEL 57" X 19" X 10" 275C

CUSTOMER SUPPORT CAN BE REACHED AT ANY OF THE FOLLOWING:

CALL: 901-372-1773

TEXT: 901-472-7797

EMAIL: support@royalswimmingpools.com



Carton Breakdown

SALTWATER ULTIMATE 15' ROUND 54''

Carton Product Number #	Carton Content Description
550015761861A	5/5 15D 761 861 AZOR

√	Key #	Qty	Part #	Part Description
<input type="checkbox"/>	*	1	SACSVCC-10	BAG 10 RIGHT/LEFT COVER-LOGO/V CROWN 15D
<input type="checkbox"/>	D	10	CC761-20851	JOINER PLATE CACAO RESIN 761 861
<input type="checkbox"/>	*	1	SACWBI36876	SAC DVD D`INSTALLATION TRENDIUM
<input type="checkbox"/>	F	20	1525515	BOTTOM RAIL 15' REGULAR CHAMPAGNE L 55-1/4"
<input type="checkbox"/>	D1	10	CG761-20852	BOTTOM PLATE RESIN COGNAC
<input type="checkbox"/>	*	1	SACRE0015	HARDWARE KIT 15D REVELATION 761 861

*Below items will contain no actual pool parts; just packaging/shipping materials

Qty	Part #	Part Description
2	BTE571906	BOX TEL REVERSIBLE 57" X 19" X 06" 275C

CUSTOMER SUPPORT CAN BE REACHED AT ANY OF THE FOLLOWING:

CALL: 901-372-1773

TEXT: 901-472-7797

EMAIL: support@royalswimmingpools.com

**SALTWATER
ULTIMATE
ROUND 54**

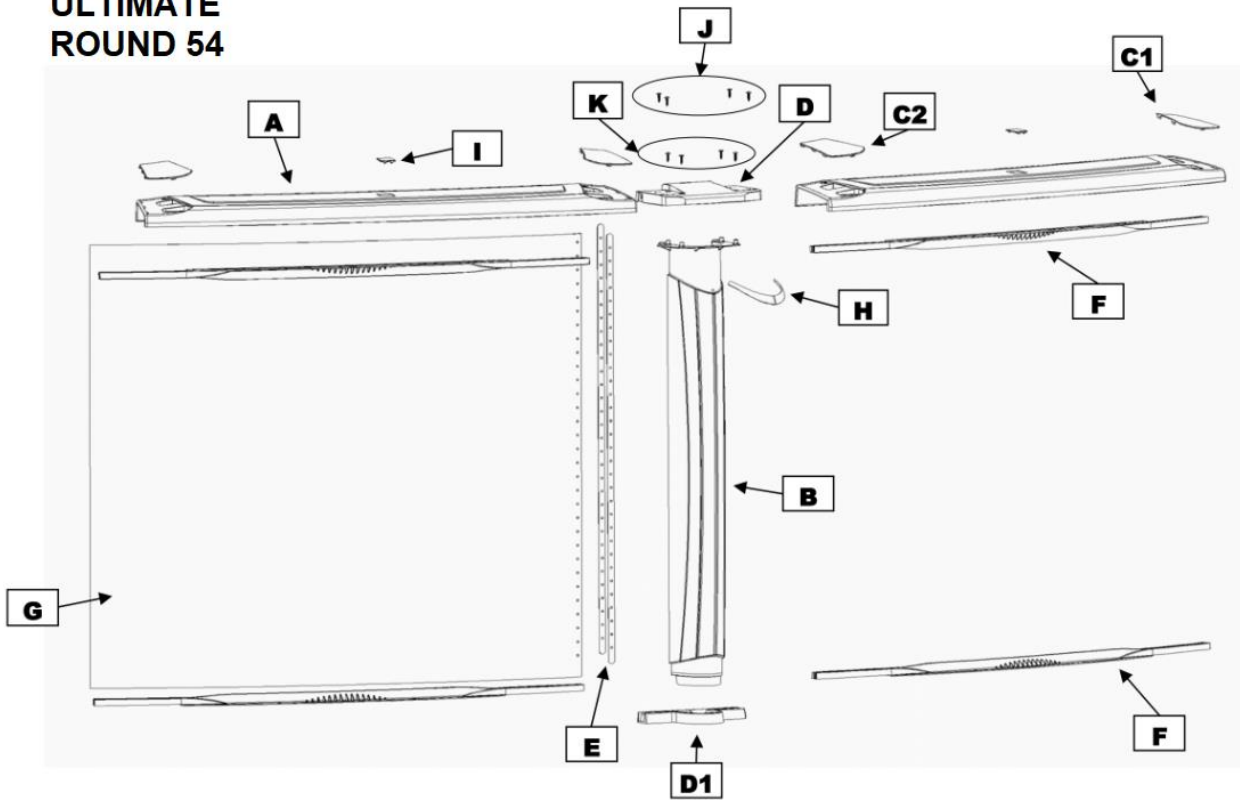

CUSTOMER SUPPORT CAN BE REACHED AT ANY OF THE FOLLOWING:
CALL: 901-372-1773
TEXT: 901-472-7797
EMAIL: support@royalswimmingpools.com