



Pool Breakdown

SALTWATER DESTINY 18'x33' OVAL 52"

This first page lists the quantity, carton number, and carton description for each individual box and/or pallet in your shipment. Check that the numbers and descriptions on your checklist match identically to those on the cartons. Make sure that the pool type, model, shape, and size also line up perfectly. If something is off, even by one number, check to make sure that you have the correct checklist for your pool type and if so, contact our support team immediately at support@royalswimmingpools.com.

√	Qty	Carton Product Number #	Carton Content Description
<input type="checkbox"/>	1	101183309380000	TOP RAIL 18X33 CHAMPAGNE BLUES
<input type="checkbox"/>	1	102183309380002	UPRIGHT 18X33 CHAMPAGNE BLUES 52'
<input type="checkbox"/>	1	134183309380002	RES KIT OVAL 1833 BLUES CHAMPAGNE 52
<input type="checkbox"/>	1	140183300420000	PRESSURE PLATES 18X33 CONTOUR (42")
<input type="checkbox"/>	1	141183300420000	STRAPS CONTOUR 18X33 (42")
<input type="checkbox"/>	1	143183300420002	METAL UPRIGHTS 18X33 CONTOUR 52" (42")
<input type="checkbox"/>	1	145000000420000	UN CHAN & GUS (42") CONT ALL SIZE CART1
<input type="checkbox"/>	1	146000000420000	UN CHAN & GUS (42") CONT ALL SIZE CART
<input type="checkbox"/>	1	WFST52S-WMN1833-1048	WALL 1833 TAMARA52

Once you have all of the cartons listed above, continue to the next page. There should be one table per carton and each carton should be gone through entirely before moving on to the next.

Please ensure that you have received the proper quantity for each item listed.

DO NOT THROW CARTONS/BOXES AWAY UNTIL AFTER THE INSTALLATION IS COMPLETE. We recommend taking photos of all labels/stickers on the boxes.

In the unlikely event that you are missing items, please refer to the document Inventory Checklist and Reporting Missing Items that was previously emailed to you.

Once you have ALL items listed on the entire inventory checklist, refer to your safety handbook and installation manual before you start the building process.

CUSTOMER SUPPORT CAN BE REACHED AT ANY OF THE FOLLOWING:

CALL: 901-372-1773

TEXT: 901-472-7797

EMAIL: support@royalswimmingpools.com



Carton Breakdown

SALTWATER DESTINY 18'x33' OVAL 52''

Carton Product Number #	Carton Content Description
134183309380002	RES KIT OVAL 1833 BLUES CHAMPAGNE 52

√	Key #	Qty	Part #	Part Description
<input type="checkbox"/>	F	8	CWI-10209000002	UPRIGHT COVER CONTOUR CHAMPAGNE 52'

*Below items will contain no actual pool parts; just packaging/shipping materials

Qty	Part #	Part Description
2	BTE572416	BOX TEL REVERSIBLE 57" X 24" X 16" 275C
2	CWI-4SEP038	SEPARATOR SHEET 52" 54 1/4 X 21 7/8
2	LN7218	SLEEVE 72" X 18"

Carton Product Number #	Carton Content Description
140183300420000	PRESSURE PLATES 18X33 CONTOUR (42")

√	Key #	Qty	Part #	Part Description
<input type="checkbox"/>	N	8	WBI-16549	PRESSURE PLATE CONTOUR OVAL (42" SECT)

*Below items will contain no actual pool parts; just packaging/shipping materials

Qty	Part #	Part Description
2	BTE501402	BOX 50" X 14" X 2"

CUSTOMER SUPPORT CAN BE REACHED AT ANY OF THE FOLLOWING:

CALL: 901-372-1773

TEXT: 901-472-7797

EMAIL: support@royalswimmingpools.com



Carton Breakdown

SALTWATER DESTINY 18'x33' OVAL 52"

Carton Product Number #	Carton Content Description
141183300420000	STRAPS CONTOUR 18X33 (42")

√	Key #	Qty	Part #	Part Description
<input type="checkbox"/>	O	8	WBI-22726	OVAL CHANNEL END CAP
<input type="checkbox"/>	M	8	WBI-16539	STRAP END CHANNEL
<input type="checkbox"/>	P	12	WBI-16726	ON-GROUND STRAP 18' CONTOUR (52.6875")

*Below items will contain no actual pool parts; just packaging/shipping materials

Qty	Part #	Part Description
2	BTE540805	BOX 54" X 8-3/4" X 5"

Carton Product Number #	Carton Content Description
143183300420002	METAL UPRIGHTS 18X33 CONTOUR 52" (42")

√	Key #	Qty	Part #	Part Description
<input type="checkbox"/>	*	1	10522117	HARDWARE 1223 / 1833 STEEL STRUCTURE
<input type="checkbox"/>	Q	8	WBI-18573	METAL UPRIGHT FOR CONTOUR OVAL 52"
<input type="checkbox"/>	T	8	WBI-29917	FOAM BLOCK
<input type="checkbox"/>	S1	8	WBI-10136R	METAL TOP PLATE CONTOUR OVAL

*Below items will contain no actual pool parts; just packaging/shipping materials

Qty	Part #	Part Description
2	BTE541904	BOX TEL REVERSIBLE 54-3/4 x 19-3/4 x 4 42BC

CUSTOMER SUPPORT CAN BE REACHED AT ANY OF THE FOLLOWING:

CALL: 901-372-1773

TEXT: 901-472-7797

EMAIL: support@royalswimmingpools.com



Carton Breakdown

SALTWATER DESTINY 18'x33' OVAL 52"

Carton Product Number #	Carton Content Description
146000000420000	UN CHAN & GUS (42") CONT ALL SIZE CART

√	Key #	Qty	Part #	Part Description
<input type="checkbox"/>	L	4	WBI-15933	UNDER CHANNEL CONTOUR
<input type="checkbox"/>	R	4	WBI-16375	GUSSET RIGHT CONTOUR
<input type="checkbox"/>	R	4	WBI-16374	GUSSET LEFT CONTOUR
<input type="checkbox"/>	*	1	WBI-16720	HWARE GUSSETS 4 PACK

*Below items will contain no actual pool parts; just packaging/shipping materials

Qty	Part #	Part Description
2	BTE521604	BOX 52" X 16" X 4-1/2"

Carton Product Number #	Carton Content Description
145000000420000	UN CHAN & GUS (42") CONT ALL SIZE CART1

√	Key #	Qty	Part #	Part Description
<input type="checkbox"/>	R	4	WBI-16374	GUSSET LEFT CONTOUR
<input type="checkbox"/>	*	1	WBI-16720	HWARE GUSSETS 4 PACK
<input type="checkbox"/>	R	4	WBI-16375	GUSSET RIGHT CONTOUR
<input type="checkbox"/>	L	4	WBI-15933	UNDER CHANNEL CONTOUR

*Below items will contain no actual pool parts; just packaging/shipping materials

Qty	Part #	Part Description
2	BTE521604	BOX 52" X 16" X 4-1/2"

CUSTOMER SUPPORT CAN BE REACHED AT ANY OF THE FOLLOWING:

CALL: 901-372-1773

TEXT: 901-472-7797

EMAIL: support@royalsswimmingpools.com



Carton Breakdown

SALTWATER DESTINY 18'x33' OVAL 52"

Carton Product Number #	Carton Content Description
101183309380000	TOP RAIL 18X33 CHAMPAGNE BLUES

√	Key #	Qty	Part #	Part Description
<input type="checkbox"/>	A	4	CWI-1071507160010	TOP TRACK CORNER 15' CHAMPAGNE REFLEXION
<input type="checkbox"/>	B	2	CWI-1081507000020	BOT TRACK CORNER 15' CHAMPAGNE RIGHT
<input type="checkbox"/>	B	10	CWI-1081507000000	BOTTOM TRACK 15' CHAMPAGNE TRUE SIZE
<input type="checkbox"/>	B	2	CWI-1081507000030	BOT TRACK CORNER 15' CHAMPAGNE LEFT
<input type="checkbox"/>	B	6	CWI-10807000042	BOT TRACK CHAMPAGNE STRAIGHT SIDE OVAL
<input type="checkbox"/>	A	10	CWI-1071507160000	TOP TRACK 15' CHAMPAGNE UNIVERSAL
<input type="checkbox"/>	A	6	CWI-10707000042	TOP TRACK CHAMPAGNE STRAIGHT SIDE OVAL
<input type="checkbox"/>	G	14	CWI-10109360000	TOP SEAT CREATION/BLUES CHAMPAGNE
<input type="checkbox"/>	G	6	CWI-10109360042	STR SIDE TOP SEAT CREATION CHAMPAGN 42"

*Below items will contain no actual pool parts; just packaging/shipping materials

Qty	Part #	Part Description
2	BTE572416	BOX TEL REVERSIBLE 57" X 24" X 16" 275C

CUSTOMER SUPPORT CAN BE REACHED AT ANY OF THE FOLLOWING:

CALL: 901-372-1773

TEXT: 901-472-7797

EMAIL: support@royalswimmingpools.com



Carton Breakdown

SALTWATER DESTINY 18'x33' OVAL 52''

Carton Product Number #	Carton Content Description
102183309380002	UPRIGHT 18X33 CHAMPAGNE BLUES 52'

√	Key #	Qty	Part #	Part Description
<input type="checkbox"/>	*	1	CWI-1051833380	HWARE 1833 BLUES OVAL
<input type="checkbox"/>	S2	8	CWI-1040033A01	TOP PLATE OVAL CONTOUR ALL/CON
<input type="checkbox"/>	I	24	CWI-6ADP10900A00	UPRIGHT ADAPTOR ALL/CON
<input type="checkbox"/>	F	12	CWI-1020009Q52	UPRIGHT CHAMPAGNE JAZZ 52"
<input type="checkbox"/>	*	1	SACWBI36875	SAC DVD D'INSTALLATION AQUALEADER
<input type="checkbox"/>	H2	20	CWI-1030009Q10	SEAT CAP CHAMPAGNE JAZZ INNER
<input type="checkbox"/>	H1	12	CWI-1030009Q00	SEAT CAP CHAMPAGNE JAZZ OUTER
<input type="checkbox"/>	E	12	CWI-11207100000	BOTTOM PLATE ALLEGRO SAND 2007
<input type="checkbox"/>	H1	8	CWI-1030009Q01	SEAT CAP OVAL CHAMPAGNE JAZZ OUTER
<input type="checkbox"/>	E	8	CWI-10409000000	BOTTOM CONNECTOR CONTOUR CHAMPAGNE

*Below items will contain no actual pool parts; just packaging/shipping materials

Qty	Part #	Part Description
2	BTE572416	BOX TEL REVERSIBLE 57" X 24" X 16" 275C
1	CWI-4MBT032	SEAT CAP+PLATES BOX 42X14 3/8 X 8 3/16
2	CWI-4SEP038	SEPARATOR SHEET 52" 54 1/4 X 21 7/8
2	LN7822	SLEEVE 78" X 22"

CUSTOMER SUPPORT CAN BE REACHED AT ANY OF THE FOLLOWING:

CALL: 901-372-1773

TEXT: 901-472-7797

EMAIL: support@royalswimmingpools.com

**SALTWATER DESTINY
OVAL 52**

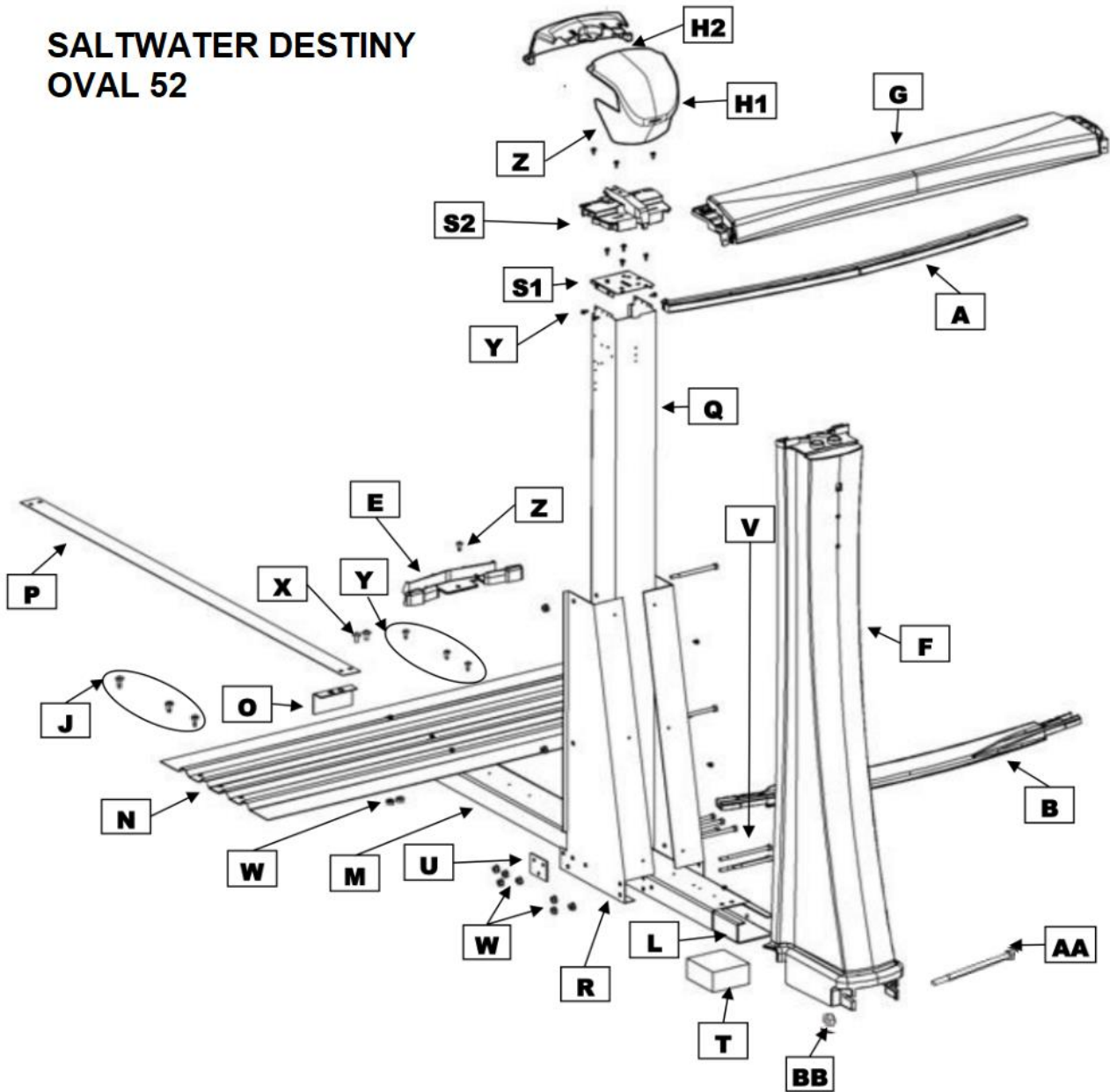

CUSTOMER SUPPORT CAN BE REACHED AT ANY OF THE FOLLOWING:
 CALL: 901-372-1773
 TEXT: 901-472-7797
 EMAIL: support@royalswimmingpools.com