

Above Ground Filter Installation - Models 5100/5200

TOOLS NEEDED

Screwdriver

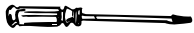

Wrench

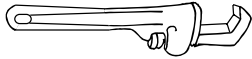

INCLUDED WITH CYCLER

-Nipple Kit

Teflon Tape



One 6" X 1 1/2" TBE PVC Nipple



MATERIALS NEEDED:

One Hose Adapter
1 1/2" X 1 1/2" X 1 1/4"

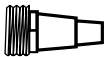

One Section of
1 1/2" Flex Hose
(provided with filter)

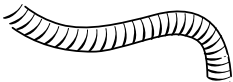

One
Hose
Clamp



RECOMMENDED:



Check Valve
Rainbow #172288



1. Apply teflon tape to each threaded end of nipple.

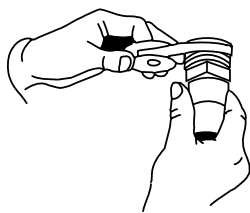

4. Apply teflon tape to threaded end of hose adapter.

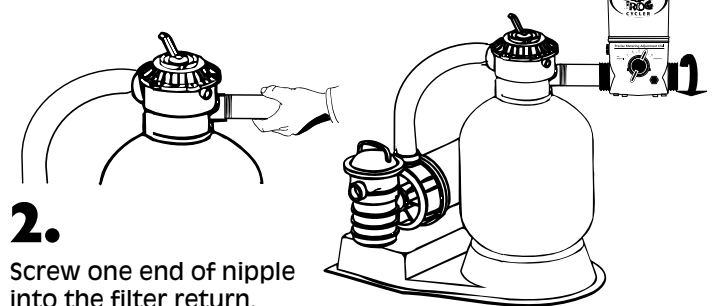

2. Screw one end of nipple into the filter return.

Tighten turning 1 to 2 revolutions with wrench. **Do NOT over tighten.**

5. Screw adapter into the right port of Cyclar.

Tighten turning 1 to 2 revolutions with wrench. **Do NOT over tighten.**

3. Screw the left port of Cyclar on to open nipple end until upright and secure.

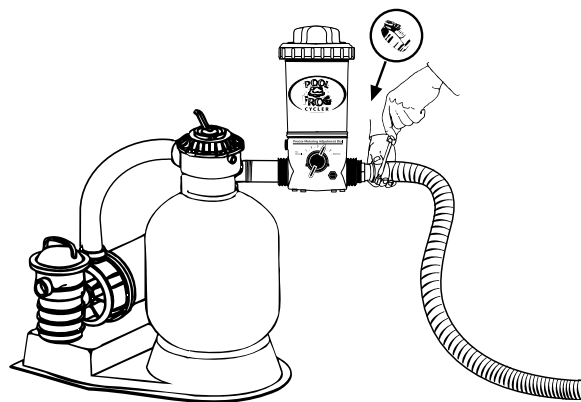
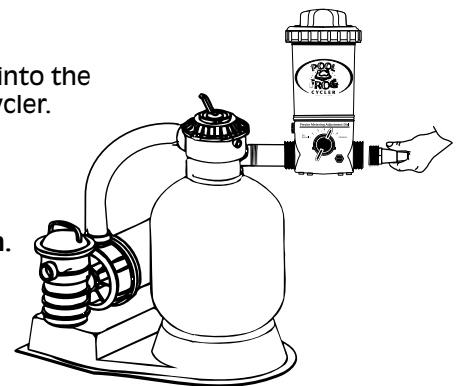

6. Attach return section of hose to the adapter with clamp. Tighten clamp with screwdriver.

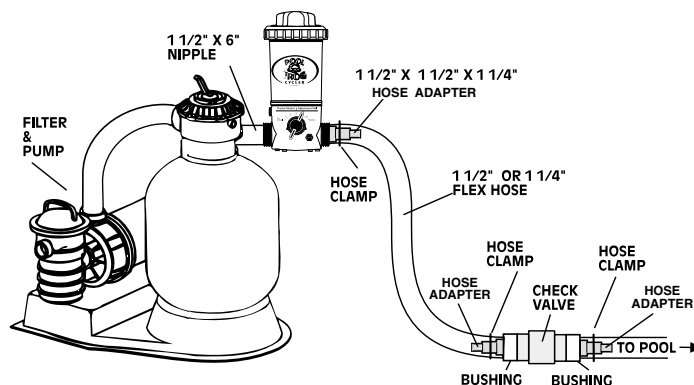

7. If using a chlorine Bac Pac installing a corrosion resistant check valve is recommended.