

| Parts List | | |
|------------|-----|----------------|
| ITE | QT | PART NUMBER |
| 1 | 31 | COP-KCVRET-W-1 |
| 2 | 1 | IPC-AB90 |
| 3 | 21' | OPC-CONREC-120 |
| 4 | 20' | SSC-1099 |
| 5 | 1 | SSC-2775 |
| 6 | 1 | SSC-2776 |
| 7 | 1 | SSC-2777 |
| 8 | 1 | SSC-2778 |
| 9 | 1 | SSC-2779 |
| 10 | 1 | SSC-2780 |
| 11 | 2 | SSC-2781 |
| 12 | 2 | SSC-2782 |
| 13 | 1 | SSC-2783 |
| 14 | 1 | SSC-2784 |
| 15 | 1 | SSC-2797 |
| 16 | 1 | SSC-2798 |
| 17 | 1 | SSC-2799 |
| 18 | 1 | SSC-2800 |
| 19 | 1 | SSC-2890 |
| 20 | 1 | SSC-2891 |
| 21 | 1 | SSC-2892 |

NOTE: PVC 6 " RADIUS INSERTS WILL BE PROVIDED WITH ALL STEP/BENCH KITS THAT HAVE 90 DEGREE CORNER.

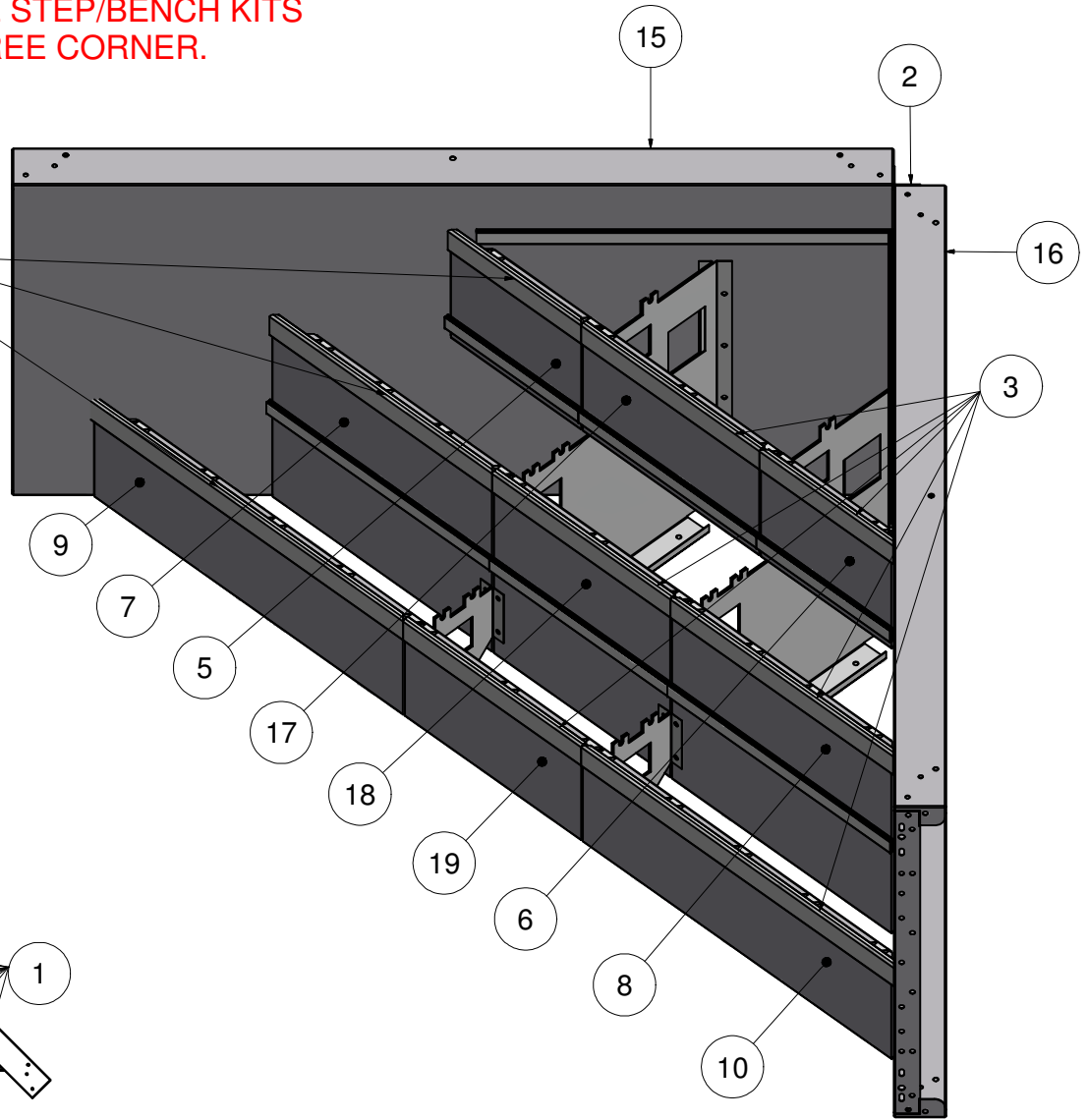

AUTOCVR OPEN TOP CN-90D 3 TRD 9'

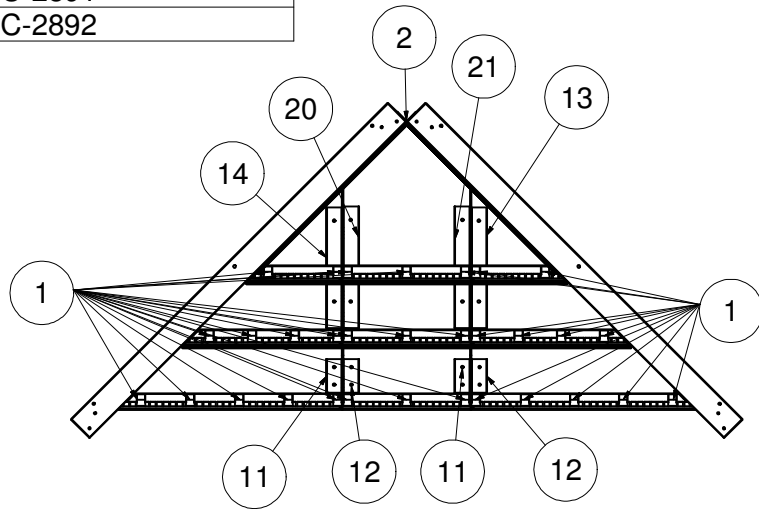

TOLERANCES EXCEPT AS NOTED:

0/0 0.0 0.00 0.000 0°

±1/8 ±0.25 ±0.0625 ±0.03125 ±1/2°

DATE : 1/12/2017

PART # : SOK-ST108ACCS90

SHEET : 2 OF 2

SECTION : 5 - 3